

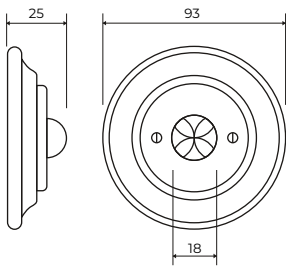

# Porcelain switches - motion sensor

# ROO

### DIMENSIONS



### VOLTAGE

220 – 240, 360°/180°/9m,  
3 sec. - 3 min.

Light sensitivity regulation:  
10 - 2000 Lux, IP20



CERTIFICATE

### WIRING DIAGRAM

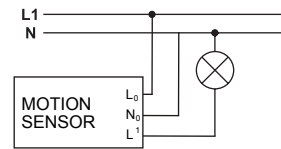

### MACHINE & WARRANTY

O3ZOR



Extended warranty:  
for porcelain: 50 years  
for el. machine: 10 years

### DISTANCE BETWEEN BOXES

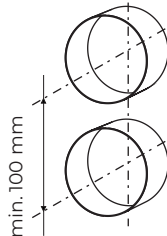

### GAP

for gap below the wall surface  
use following reduction

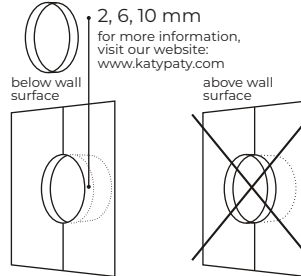

### COLORS (SURFACE)

Glossy  
Matt

### SCREWS



Stainless  
Black  
Silver  
Brass  
White

### TIGHTENING TORQUE



Tightening torque  
for porcelain **max** 0,1N



Tightening torque  
for wirings **max** 1N



### ASSEMBLY

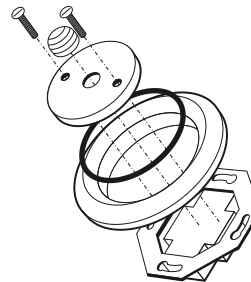

### COMPATIBILITY OF BOXES



✓ Coupling  
KATY PATY



NO

### FRAGILE



HANDLE WITH CARE

### BLOCKED FOR TRANSPORT

Weight: 100g